

Rexnord® Magnetflex® Tubular Corner Return

Non Marking return for Plastic TableTop Chains & Chainbelts

The Rexnord® Magnetflex® system has become the worldwide standard in the beverage industry. The great advantages of this system have made it the choice of the worlds leading OEM's. Magnets underneath the track hold the chain down in a reliable way.

With todays high speed conveyor applications and sometimes also abrasive conditions, it is required that the chain surface remains in optimum condition to avoid any unwanted product handling issues. On some occasions we found that abrasive parts cause unwanted wear of the chain surface. To ensure the

chain surface of plastic TableTop chains remain in perfect condition in high speed and abrasive applications, Rexnord has developed a special Non Marking return section to be combined with the standard Magnetflex upper part. This new returnpart features a Stainless Steel tubular return which reduces abrasive wear of the chain topsurface.

The result is that the chain surface will remain in perfect condition over a long period of time, and optimum product handling at high speeds can be achieved.

Features & Benefits

- Designed to eliminate marks on the conveying surface of the chain caused by the curve return, typically in abrasive and high speed applications.
- Solution is a metal tubular return where no debris can embed and chain surface is protected.
- Chain surface remains in optimum condition, avoiding bottle stability issues.
- Machined guideshoe is not recommend in combination with Non Marking return.
- Available as standard in the following executions:

Combi-A C6T

Suitable for Plastic TableTop range RHMP & RHMDP

Combi-A CB6T

Suitable for Chainbelt series FGM1050 and FTM1060

Combi-A CC6T

Suitable for Heavy Duty Chainbelt FTM1055

- Available upon request for any other corner track execution
- Suitable for Plastic TableTop chain and Plastic Chainbelts only

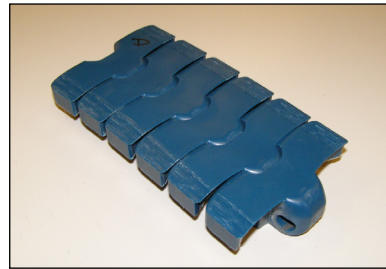

Marking on surface of the chain in abrasive applications

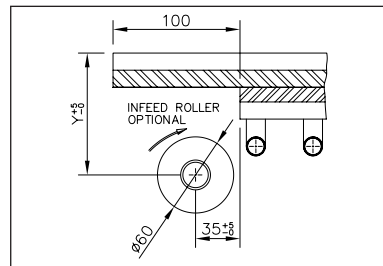

Optimum combination with infeed roller



Single track version

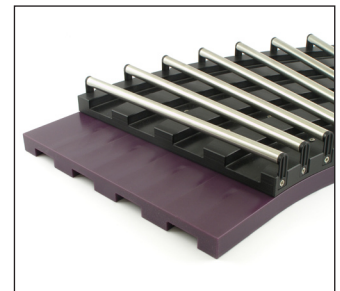

Multiple track version

WORLDWIDE CUSTOMER SERVICE

AUSTRALIA

Rexnord Australia Pty. Ltd.
Picton, New South Wales
Phone: 61-2-4677-3811
Fax: 61-2-4677-3812

BRAZIL

Rexnord Correntes Ltda.
Sao Leopoldo - RS
Phone: 55-51-579-8022
Fax: 55-51-579-8029

CANADA

Rexnord Canada Ltd.
Scarborough, Ontario
Phone: 1-416-297-6868
Fax: 1-416-297-6873

CHINA

Rexnord China
Shanghai
Phone: 86-21-62701942
Fax: 86-21-62701943

FLATTOP EUROPE

Rexnord FlatTop Europe b.v.
's-Gravenzande, The Netherlands
Phone: 31-174-445-111
Fax: 31-174-445-222

After Hours/Emergency Phone:
31-174-445-112

Rexnord Marbett®, S.r.l.
Correggio (RE), Italy
Phone: 39-0522-639333
Fax: 39-0522-637778

RMCC Deutschland Kette GmbH
Phone: 0800 5888083
Fax: 0800 5888084

Rexnord FlatTop France
Phone: 0805 54 04 44
Fax: 0805 54 05 55

MEXICO

Rexnord S.A. de C.V.
Queretaro, Qro.
Phone: 52-442-218-5000
Fax: 52-442-218-1090

UNITED STATES

Customer Service
Phone: 1-866-REXNORD
(1-866-739-6673)
Fax: 1-614-675-1898
E-mail: rexnordcs(state)@rexnord.com
Example: rexnordcsohio@rexnord.com

Rexnord FlatTop North America
Grafton, Wisconsin
Phone: 1-262-376-4700
Fax: 1-262-376-4720

Rexnord International - Power Transmisson
Milwaukee, Wisconsin
Phone: 1-414-643-2366
Fax: 1-414-643-3222
international2@rexnord.com

ALL COUNTRIES NOT LISTED

Rexnord FlatTop Europe b.v.
's-Gravenzande, The Netherlands
Phone: 31-174-445-111
Fax: 31-174-445-222

After Hours/Emergency Phone:
31-174-445-112

INDIA

Rexnord India Pvt Ltd
Pune, India
Telefon: 91-20-40160888