

Side Guide Adjustment™

The Value of Productivity

Rexnord® Marbett® MCC®



FlatTop Global

REXNORD
PRECISION. POWER. PERFORMANCE.

Rexnord - Precision. Power. Performance.

Rexnord® is a trusted name when it comes to providing skillfully engineered products that improve productivity and efficiency for beverage, container making, food and industrial applications worldwide.

We are committed to exceeding customer expectations in every area of our business.

Rexnord represents the most comprehensive portfolio of conveying and power transmission components in the world with brands like Rexnord®, MCC®, Marbett®, Falk™ and Link-Belt®.

Proven products, Superior Performance, the Right People - From a single source

One feature of the industrial landscape never changes: Reliance on essential products that give it strength and staying power.

Now, more than ever, the need for a profitable solution - from one single flexible and reliable partner - is critical.

No other company can offer such a diverse and extensive selection of conveying chain and components, as well as power transmission products, essential to keeping any industry on the move.

And no other company stands ready to back these products with the same measure of application and service support.

For decades, we at Rexnord have been primary source of conveying and power transmission products for industries around the globe.

Rexnord conveying solutions - The value of productivity

Keeping up with Productivity

Perhaps the strongest advantage of Rexnord® FlatTop conveying solutions lies in the shared goal of meeting your productivity needs - now and in the future: ever improving productivity performance, environmental sustainability, higher standards for safety, increasing levels of efficiency through strategic technology innovation, and continuous improvement in operating cost.

From chain design to material innovation, we are developing the conveying technology to support your continuous productivity improvements.

With over 70 years of conveying experience, Rexnord FlatTop has continued to advance reliability, speed, wear resistance, product handling, and chain life of both metal and plastic TableTop®, MatTop®, PlateTop chains and Marbett components.



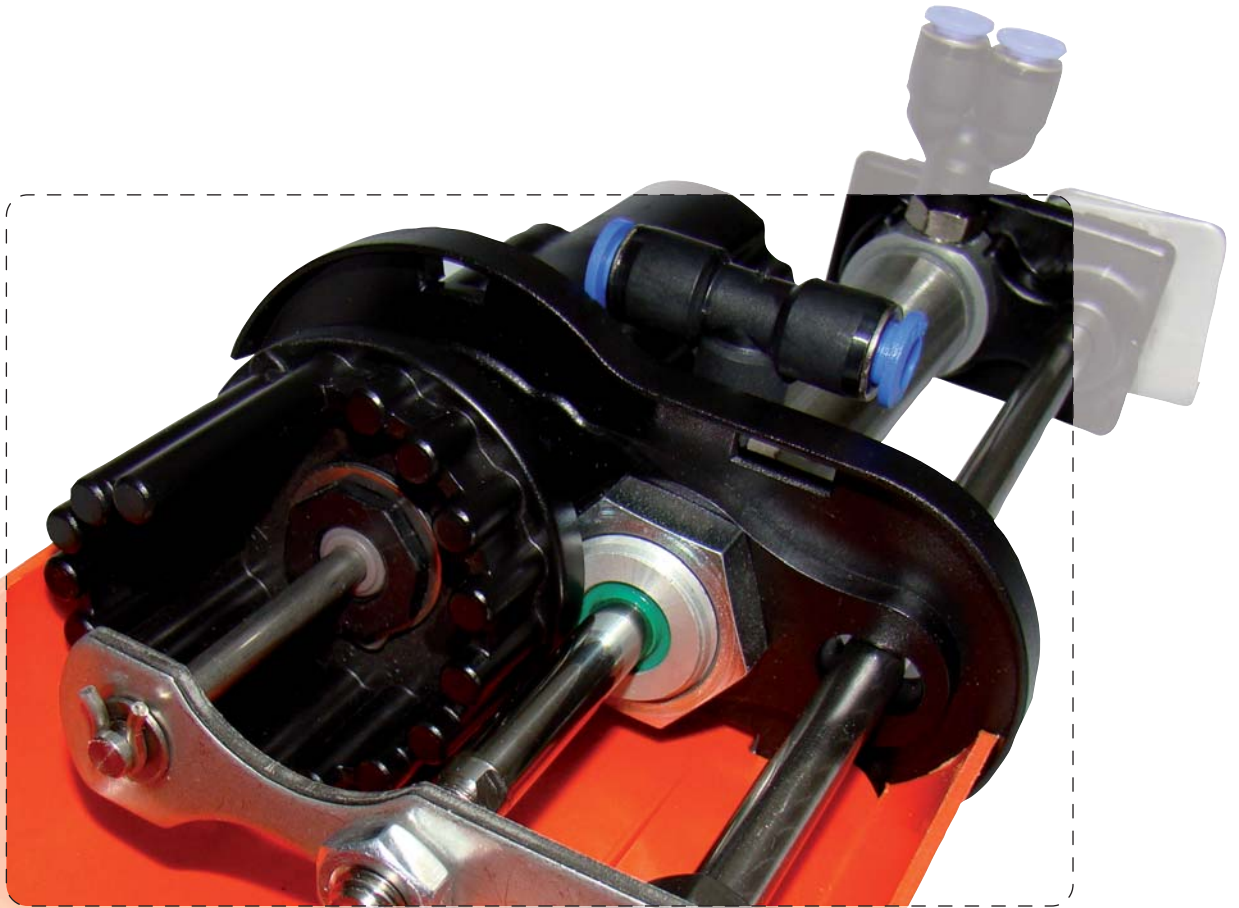

Content

Introduction

3

Component's description

4

How it works

5

Installation on air conveyors

6

Installation on chain conveyors

7

Technical information

8

9

Introduction

One of the trends identified in the beverage sector is the increasing number of shapes and sizes of containers to be handled in the same line.

SGA™ (**Side Guide Adjustment™**) is a mechanical/pneumatic system that allows an automatic adjustment of the position of the product side guides on the conveying line.

SGA™ system uses a standard pneumatic cylinder, with a maximum stroke of 30mm, adjustable to 16 different positions in increments of 2mm. All operating units work in sync placements by air pressure only.

Example of change size from 0,5 to 2 litres bottle using **SGA™** system

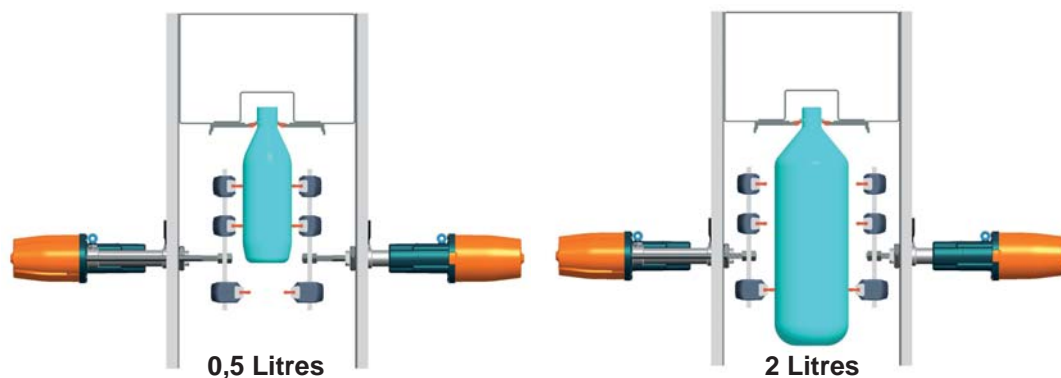

SGA™ Side Guide Adjustment™

One air piston for multiple bottle sizes

Simple single air pressure pipe connected to one piston on each vertical support

Low cost system based on pressurized air

High reliability and waterproof IP67

Old Systems

Multiple pistons, one for each bottle size

Many air pressure pipes connected to many pistons on each vertical support

High cost systems based on electric motors

Problems of reliability typical of electric contacts

Component's description

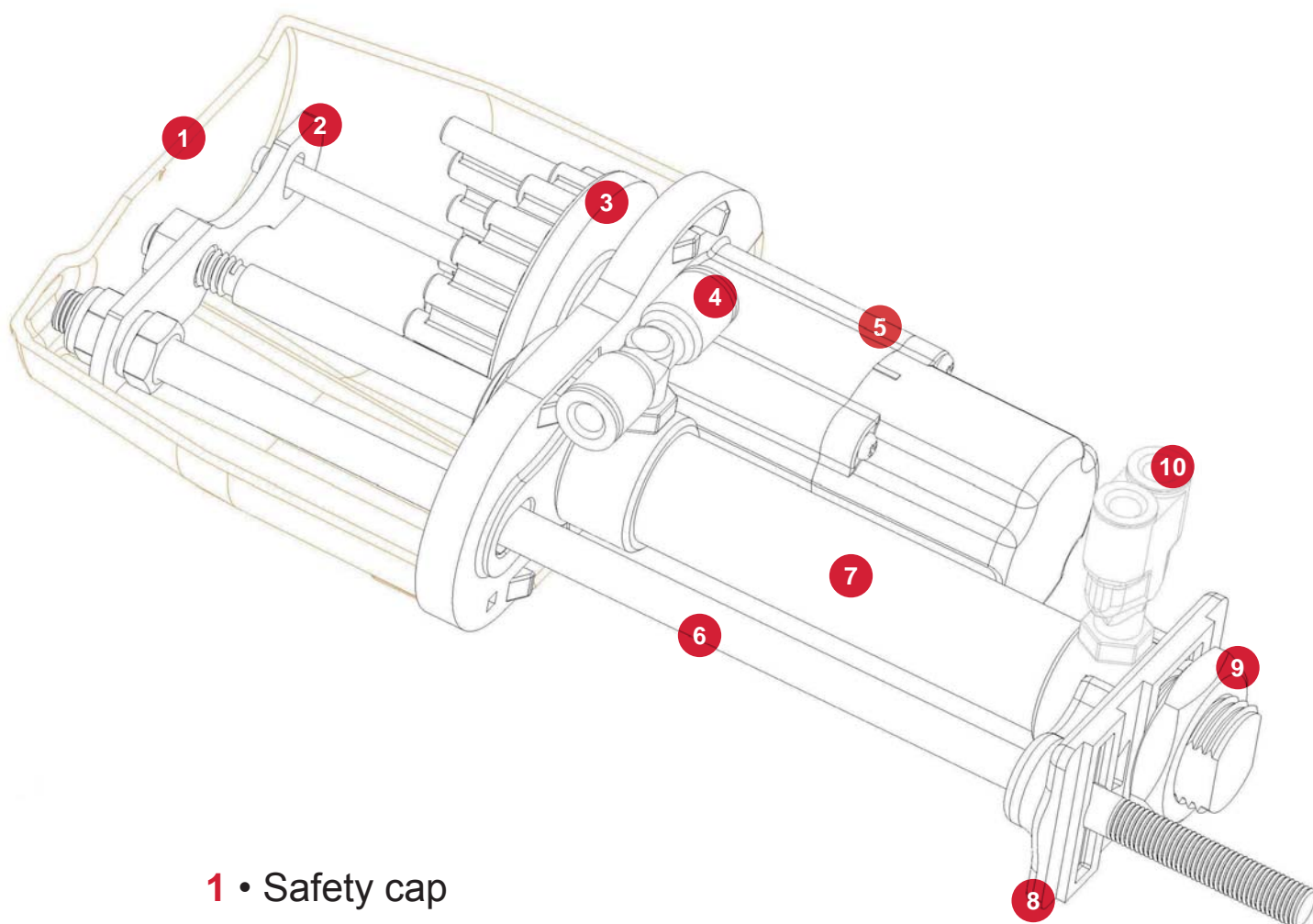

- 1 • Safety cap
- 2 • Stop plate
- 3 • Selector drum
- 4 • Quick coupling "T" 1/8 GAS
- 5 • **SGA™** operating unit
- 6 • Rod clamp
- 7 • Mini-cylinder ISO 6432
- 8 • Mounting support
- 9 • M22 nut
- 10 • Quick coupling "Y" 1/8 GAS

How it works

Every extension followed by backward movement of the piston rod, operated exclusively by air pressure, determine the rotation of $\frac{1}{16}$ of a turn of the limiter/selecter drum stroke.

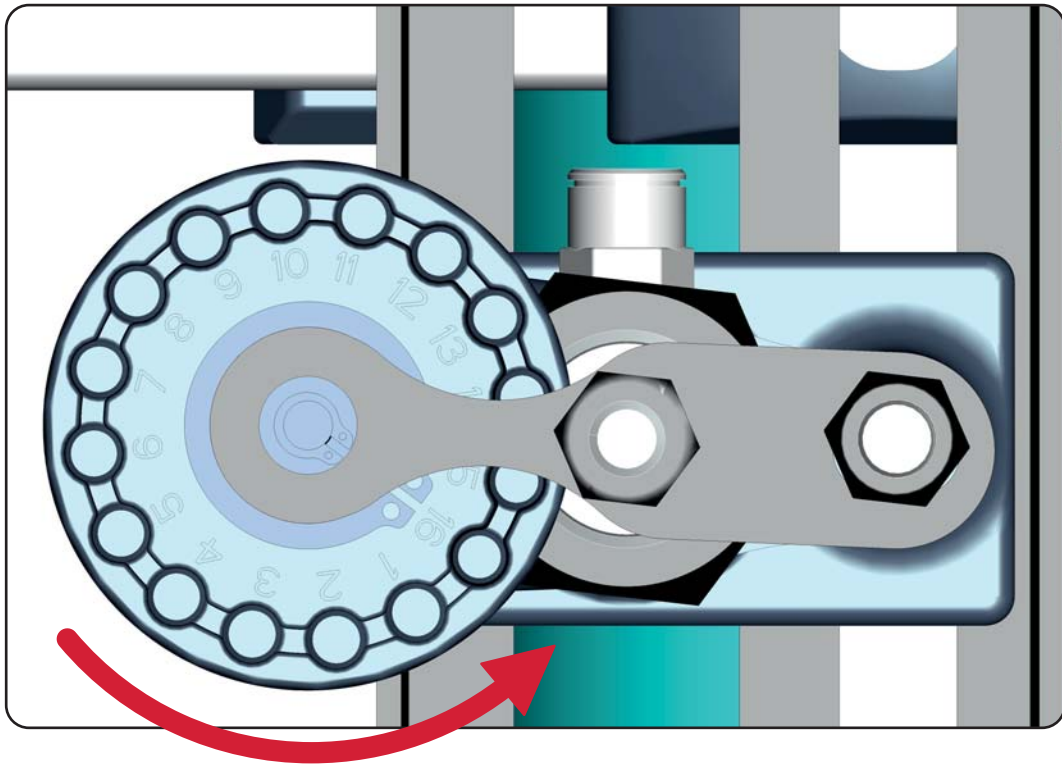

Each of the 16 angular positions of the drum, selectable cyclically and sequentially, corresponds to a specific end of stroke for the pneumatic piston rod and consequently to a position of the product side guide.

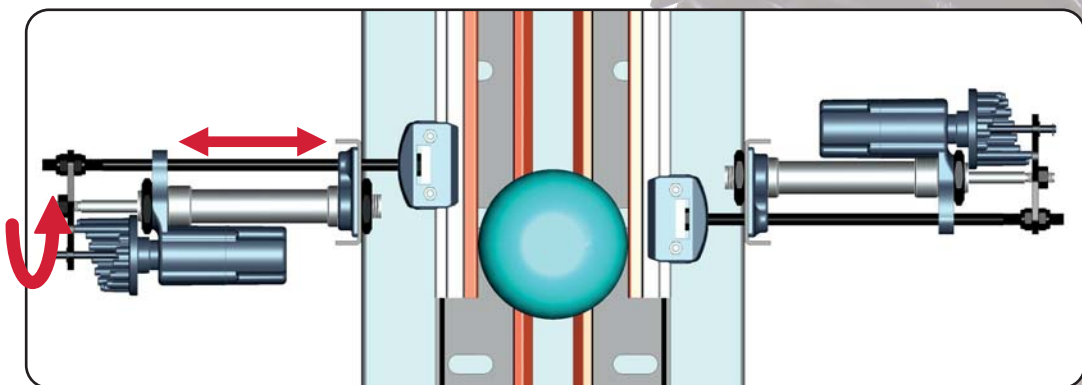

Installation on air conveyors

Each unit can be assembled on supporting profiles with holes or slots according to the dimensions suggested in the below pictures.

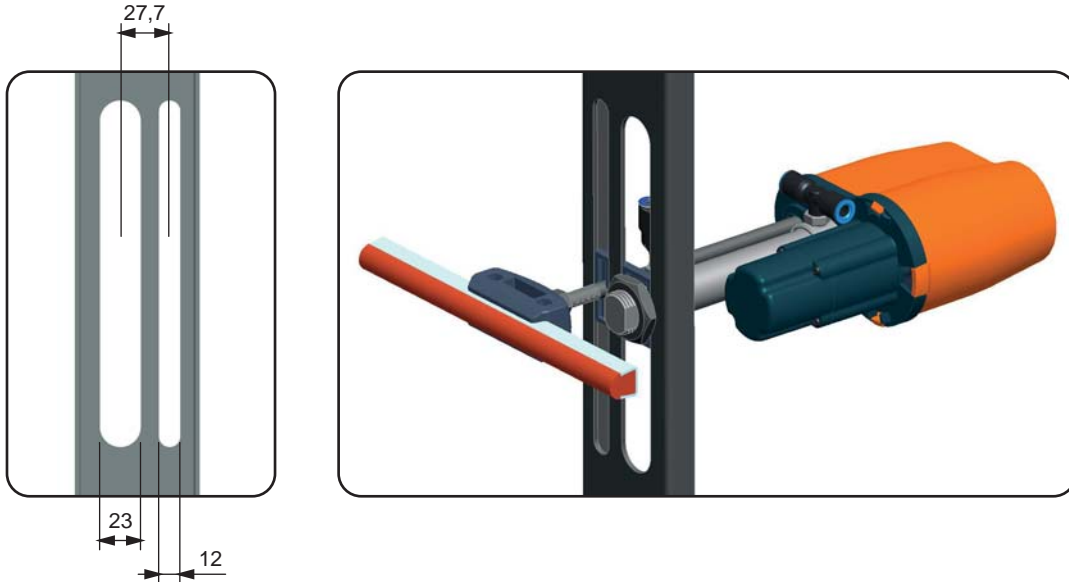

Example of installation of **SGA™** system (**Side Guide Adjustment™**) on an air conveyor.

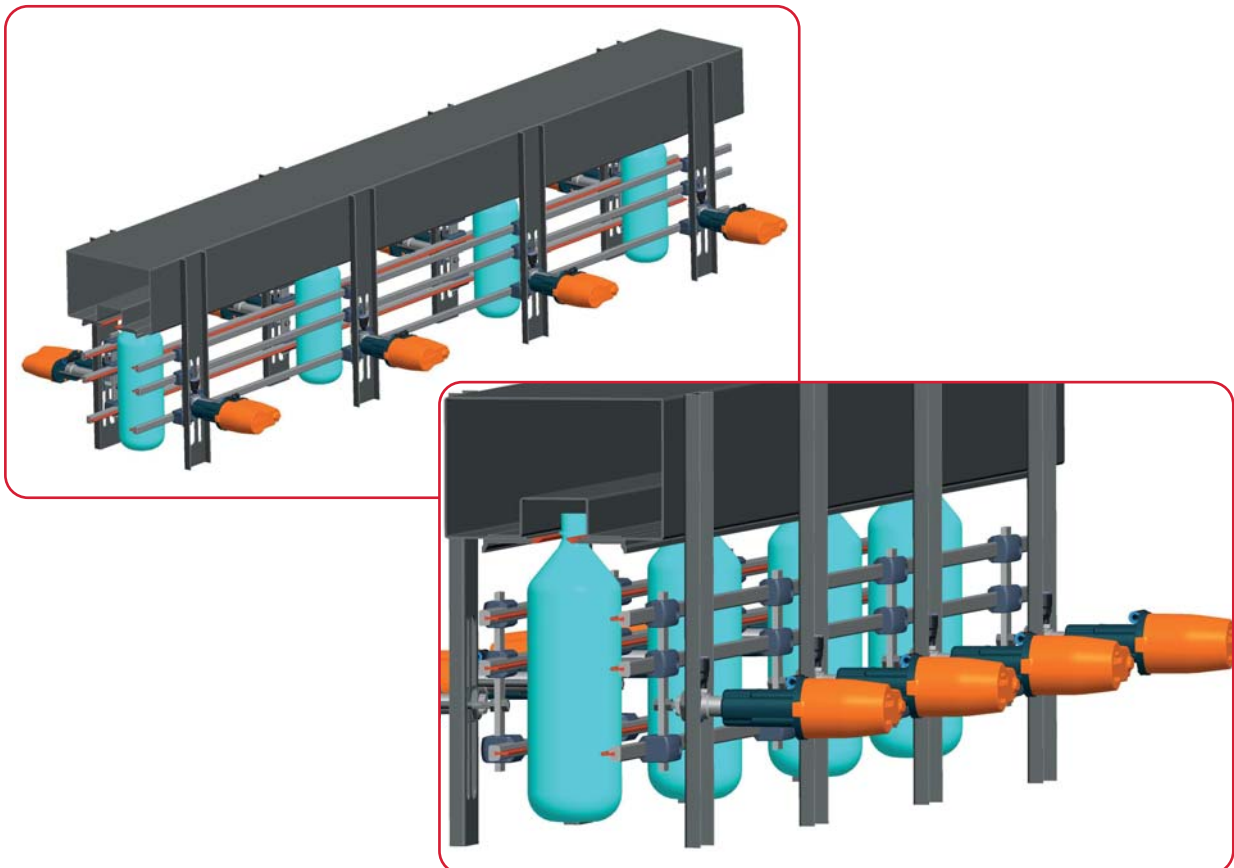

Installation on chain conveyors

Each unit can be assembled on supporting bars with holes according to the dimensions indicated in the below pictures.

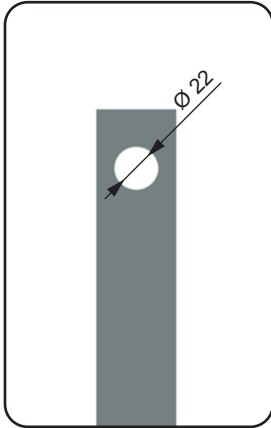

Example of installation of **SGA™** system (**Side Guide Adjustment™**) on a chain conveyor.

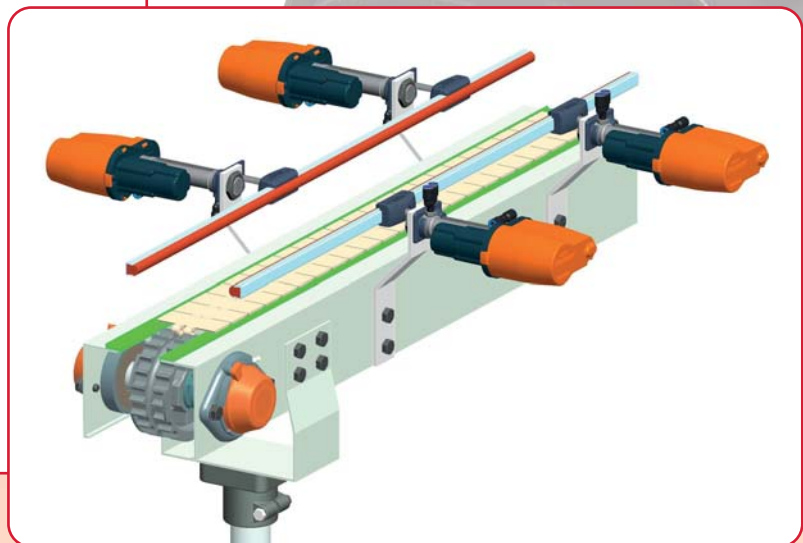

Technical information

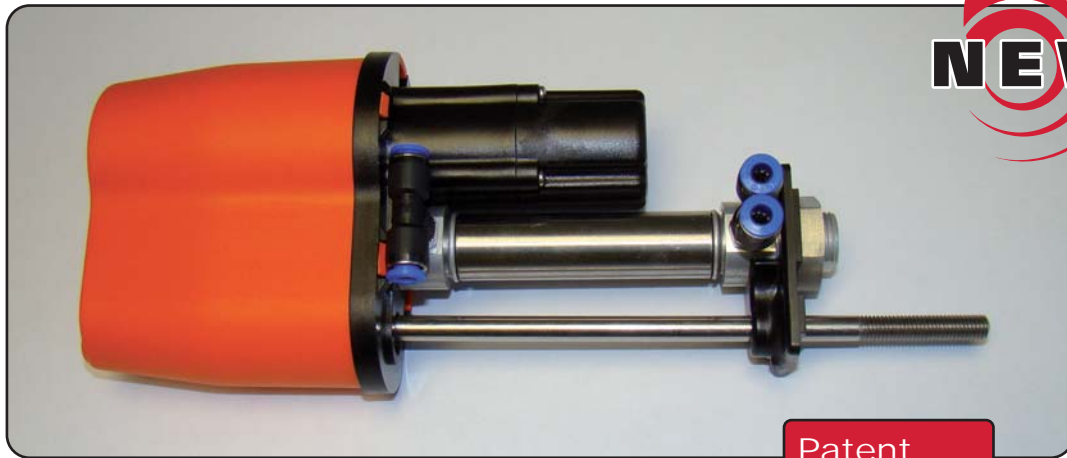

Patent Pending

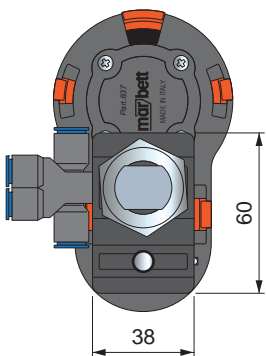
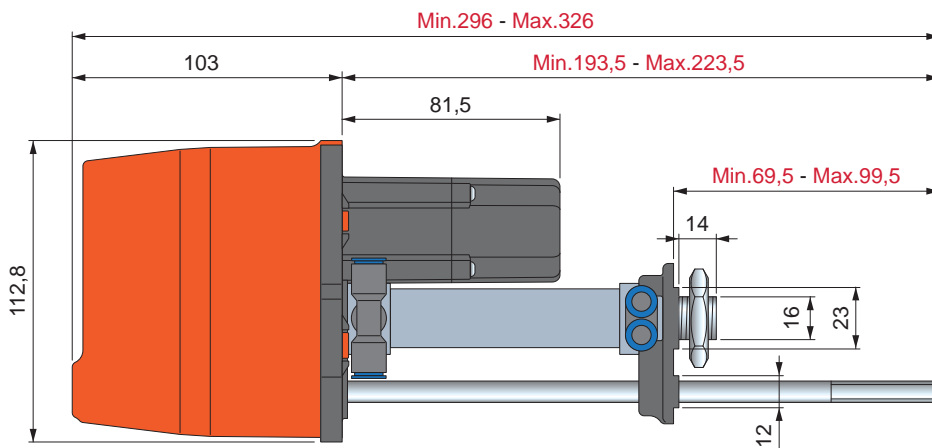
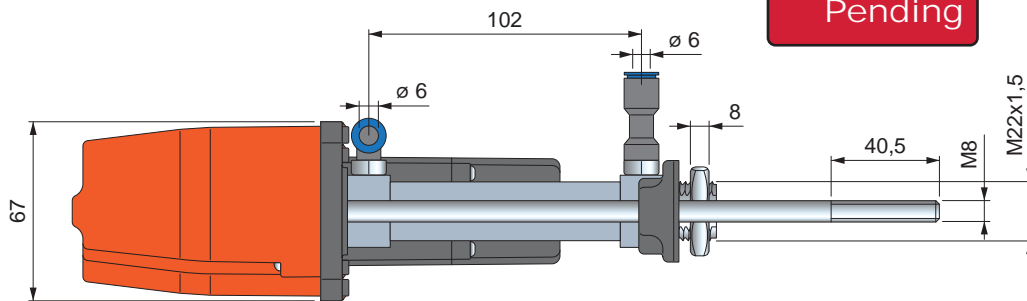

Part.	Code	Weight kg
S0837	640783	0,68

- Operating unit SGA™, selector drum and mounting support in acetal POM black.
- Safety cap in Polypropylene PP orange.
- Stop plate, rod clamp and M22 nut in stainless steel.
- Quick coupling in plastic.
- Mini-cylinder ISO 6432.
- Packaging : 4 pieces.

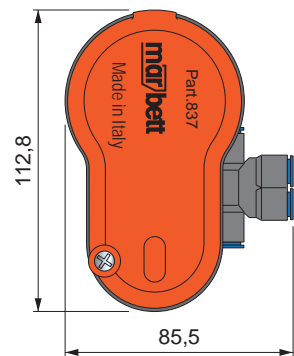

Technical information

Example of side guide assembly.

For further details about guides and clamps indicated please consult Marbett® Catalogue Conveyor Components.

Clamp Part. 215

Guides Part. 223 - 317
 219 - 373 - 393
 596 - 308
 715 - 765
 767 - 768
 769 - 770

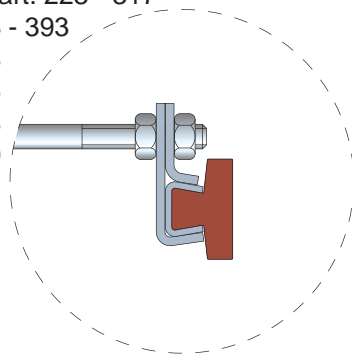

Clamps Part. 159 - 437 - 451

Round guides Dia. 8 - 10 - 12 - 14

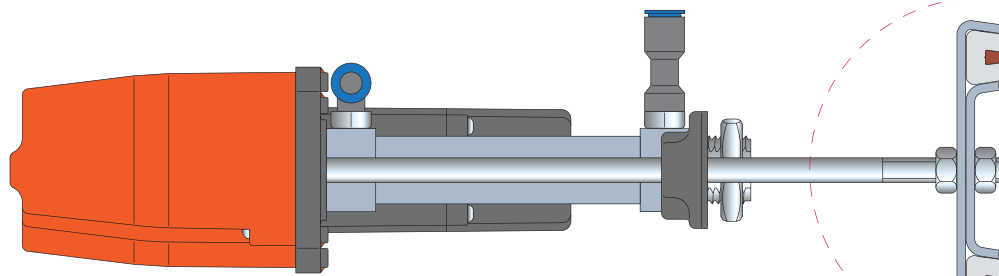
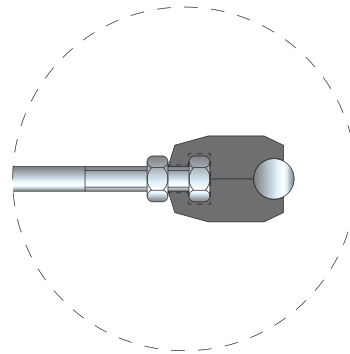

Clamp Part. 215

Guides Part.
 223 - 317
 219
 373
 393
 596
 308
 715
 765
 767 - 768
 769 - 770

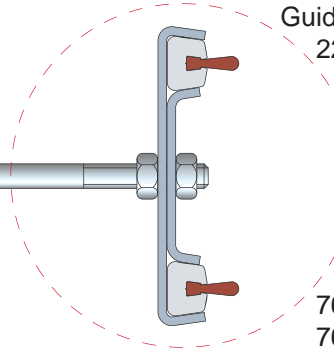

Clamps Part. 211 - 446

See 215

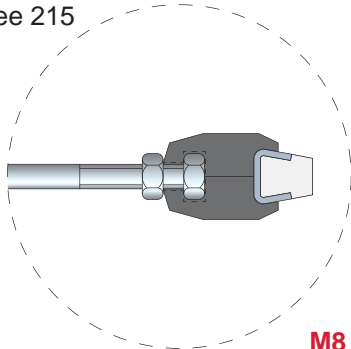

M8 nut UNI 5589-65

Guides Part. 756 - 757

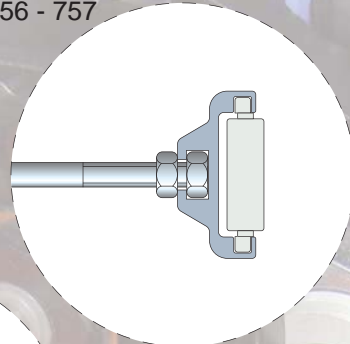

M8 nut UNI 5589-65

Guides Part. 346 - 832

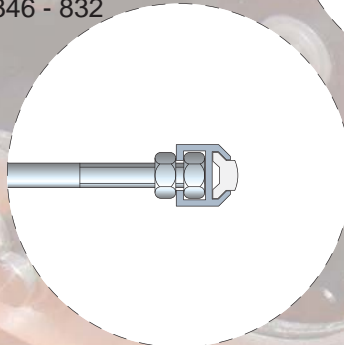

World Class Customer Service

For more than 100 years, the dedicated people of Rexnord have delivered excellence in quality and service to our customers around the globe. Rexnord is a trusted name when it comes to providing skillfully engineered products that improve productivity and efficiency for industrial applications worldwide. We are committed to exceeding customer expectations in every area of our business: product design, application engineering, operations, and customer service.

Because of our customer focus, we are able to thoroughly understand the needs of your business and have the resources available to work closely with you to reduce maintenance costs, eliminate redundant inventories and prevent equipment down time.

Rexnord represents the most comprehensive portfolio of power transmission and conveying components in the world with the brands you know and trust.

WORLDWIDE CUSTOMER SERVICE

AUSTRALIA

Rexnord Australia Pty. Ltd.
Picton, New South Wales
Phone: 61-2-4677-3811
Fax: 61-2-4677-3812

BRAZIL

Rexnord Correntes Ltda.
Sao Leopoldo - RS
Phone: 55-51-3579-8043
Fax: 55-51-3579-8049

CANADA

Rexnord Canada Ltd.
Scarborough, Ontario
Phone: 1-416-297-6868
Fax: 1-416-297-6873

CHINA

Rexnord China
Shanghai
Phone: 86-21-62701942
Fax: 86-21-62701943

FLATTOP EUROPA

Rexnord FlatTop Europe b.v.
's-Gravenzande, The Netherlands
Phone: 31-174-445-111
Fax: 31-174-445-222

Rexnord Marbett S.r.L.
Correggio (RE), Italy
Phone: 39-0522-639333
Fax: 39-0522-637778

Rexnord Flattop France
Phone: 0805-540-444
Fax: 0805-540-555
E-mail: rexnord.marbett@rexnord.com

Rexnord Deutschland Kette GmbH
Phone: 0800-588-8083
Fax: 0800-588-8084

INDIA

Rexnord India Pvt Ltd
Pune, India
Phone: 91-20-20160888

MEXICO

Rexnord FlatTop
Toll-Free Phone: 1-888-808-7787
Fax: 1-262-376-4720

UNITED STATES

Customer Service
Phone: 1-866-REXNORD
(1-866-739-6673)
Fax: 1-614-675-1898
E-mail: rexnordcs(state)@rexnord.com
Example: rexnordcsohio@rexnord.com

Rexnord FlatTop North America
Grafton, Wisconsin
Phone: 1-262-376-4700
Fax: 1-262-376-4720

Rexnord International - Power Transmission
Milwaukee, Wisconsin
Phone: 1-414-643-2366
Fax: 1-414-643-3222
E-mail: international2@rexnord.com

ALL COUNTRIES NOT LISTED

Rexnord FlatTop Europe b.v.
's-Gravenzande, The Netherlands
Phone: 31-174-445-111
Fax: 31-174-445-222

After Hours/Emergency Phone:
31-174 445 112

